

性能参数 Specifications

| 项目 Item                            | 单位 Unit | 参数 Parameter |
|------------------------------------|---------|--------------|
| 主机型号 Main machine model            |         | SUM5300B     |
| 熨平板型号 Screed model                 |         | UY045YS      |
| 理论摊铺效率 Theor.Laydown rate          | t/h     | 300          |
| 最大摊铺厚度 Max.layerthickness          | mm      | 200          |
| 摊铺速度 Oprating speed                | m/min   | 0~16         |
| 行驶速度 Transport speed               | km/h    | 0~12         |
| 料斗容积 Hopper capacity               | t       | 10           |
| 电压 Voltage                         | V       | 24           |
| 控制方式 Control mode                  |         | 数字网络         |
| 熨平板型式 Screed type                  |         | 单夯锤液压伸缩      |
| 熨平板加热方式 Screed heating mode        |         | 气            |
| 基本宽度 Operating width               | m       | 1.8~3.5      |
| 最大宽度 Max. width                    | m       | 4.5          |
| 发动机型号 Engine model                 |         | BF4M2012     |
| 发动机功率 Engine power                 | kW/rpm  | 80/2000      |
| 排放 Emission                        |         | 国Ⅲ/欧ⅢA       |
| 宽度(W) Width                        | mm      | 1973         |
| 长度(L) Length                       | mm      | 6118         |
| 高度(H) Height                       | mm      | 3550         |
| 运输高度(H1) Height                    | mm      | 2918         |
| 主机运输重量(含基本熨平板) Main machine Weight | kg      | 12175        |
| 整机重量 Overall weight                | kg      | 13000        |

注：1.实际摊铺效率随摊铺宽度、厚度、速度、熨平板型式及施工工艺配套等因素变化；2.所有质量数据不包含选装件。  
3.技术参数如有变化，恕不另行通知。

陕西建设机械股份有限公司（本部）

SHAANXI CONSTRUCTION MACHINERY CO.,LTD.  
24小时服务热线 24 hours on-line:400 998 8620  
网址 <http://www.scmc-xa.com>  
公司地址：中国西安经开区泾渭新城泾朴路11号  
Address:No.11 Jingpu Road,Jingwei New Town,Economic development Zone Xi'an,China  
邮编 Zip Code: 710201  
电话 Tel : 029-86969808 86969810  
传真 Fax : 029-86969817

更多信息请关注：



官方网站



微信公众号



24小时服务热线:400 998 8620

# SUM5300B 轮式沥青混凝土摊铺机

SUM5300B  
Wheeled Tracked Paver





# 特点介绍 Feature Introduction

## SUM5300B Wheeled Tracked Paver 轮式沥青混凝土摊铺机



### ① 动力强劲

#### Forceful Power ▶

道依茨(大连)柴油发动机强劲动力80kW，排放符合国Ⅲ标准；独立复合散热系统可适应最高达45℃的环境温度。

Deutz EFI engine has a forceful power of 142kW, Meet China Ⅲ emission standards. The independent composite cooling system can adapt the highest ambient temperature of 45℃.

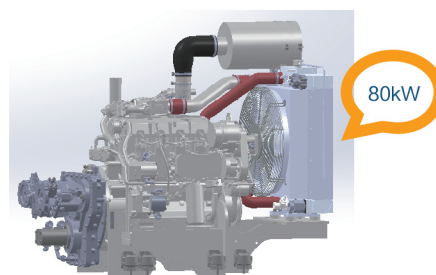

### ⑤ 加长料斗

#### Extended Hopper ▶

小机型大容量加长料斗，可满足大型自卸卡车卸料。

The small extended hopper with large capacity can meet the unloading of large dump trucks.

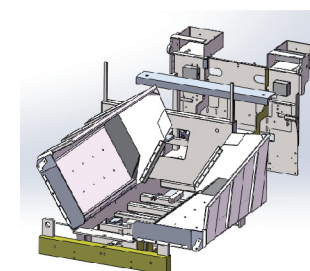

### ③ 前轮转向

#### Front-wheel Steering ▶

液压驱动的摆动式前转向桥可确保前轮在不平整的基层路面上始终接地并可可靠转向。

The hydraulically-driven oscillating front steering axle ensures that the front wheels are always grounded and reliably turned on uneven ground surface.

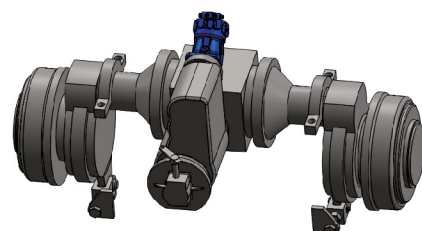

### ② 网络控制

#### Network Control

基于整机数字网络控制的可滑转主控制台易于操作诊断与维护；一键切换SMART经济功率模式。

The operating system based on digital network control of complete machine is easy to be operated, diagnosed and maintained. A key switch SMART Economy power mode. This external control panel consist of touch switches.

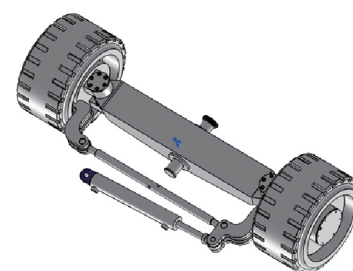

### ⑦ 布料驱动

#### Distributing Drive ▶

布料器左右独立液压驱动，超声波传感器自动控制连续比例供料；独有的布料浆叶，减少中间带离析。

The distributor is independently driven hydraulically on the left and right sides, and the ultrasonic sensor automatically controls the continuous proportional feeding; the unique distributing blade.

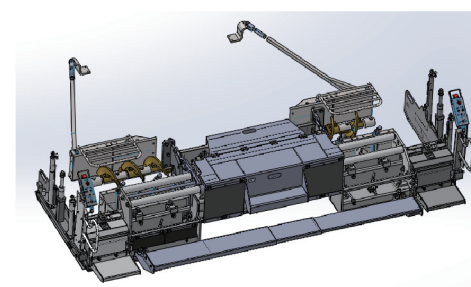

### ⑥ 刮板驱动

#### Scraper Drive

刮板左右独立液压驱动，窄宽度双排输送链使送料更加平稳；角度传感器自动控制连续供料。

The scraper is independently hydraulically-driven on the left and right sides, and the narrow double-row conveyor chain makes the feeding more stable; the angle sensor automatically controls the continuous feeding.

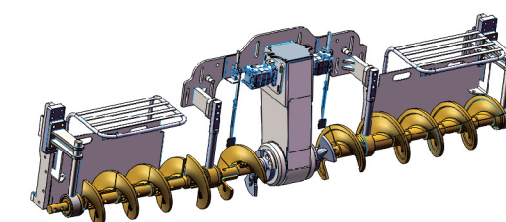

### ⑧ 宽度最小

#### Minimum Width

配置单夯锤气加热液压伸缩熨平板，最小摊铺宽度仅1.8m，适用城市道路、居民小区、园林道路等窄幅多变路面的铺筑与养护。

It is equipped with a single hammer-gas heated hydraulic telescopic screed with a minimum paving width of only 1.8m. So it is suitable for the paving and curing of narrow and variable road surfaces like urban roads, residential quarters and garden roads.